

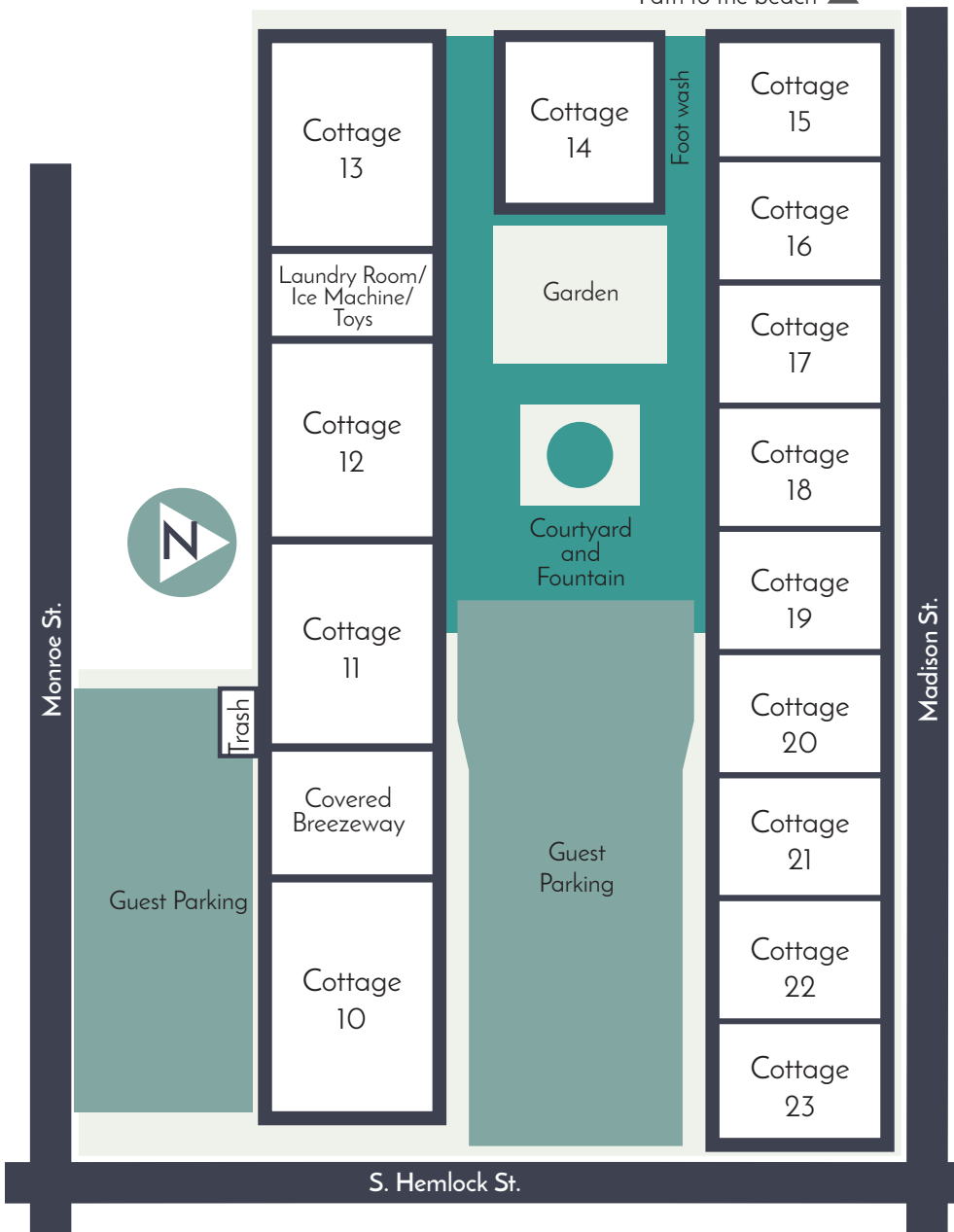

Inn at Haystack Rock - Site 2

632 S. Hemlock St. | Cannon Beach, OR 97110
503-436-2714 | innathaystackrock.com

Path to the beach ▲



Inn at Haystack Rock - Site 1

487 S. Hemlock St. | Cannon Beach, OR 97110
503-436-2714 | innathaystackrock.com

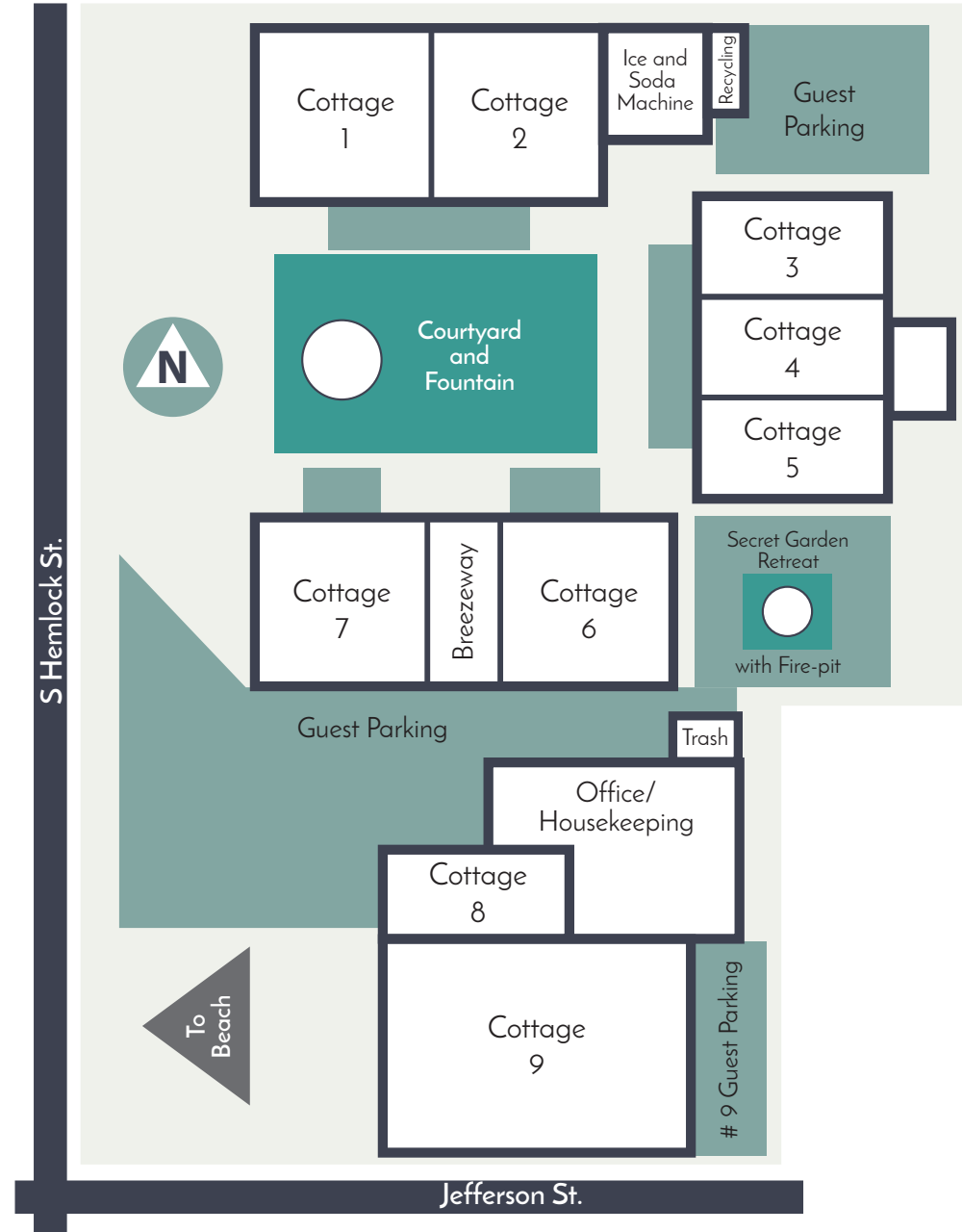



City Parks & Recreation Areas

Les Shirley Park - 5th and N Hemlock Street: Located on the north side of the Ecola Creek estuary, the park offers beach access, an expanse of lawn and picnic areas. Features include restrooms, public parking, picnic tables, interpretive signs and shuttle stop. **Ecola Creek Park** - Fir Street and Beaver. A small natural area on the shore of Ecola Creek.

City Park - Spruce Street and 2nd: The downtown park offers lawn and athletic fields, picnic tables, playground equipment, tennis courts, half-court basketball court and skateboard park. Features include parking and picnic tables, restrooms and shuttle stop located across 2nd street.

Natural Areas

The Beach
Cannon Beach offers nearly four miles of sandy public beach with 44 public beach access points. Four main public parking areas offer nearby beach access:

TOLOVANA PARK: Public parking at the Tolovana Wayside with beach access (ADA accessible) on the west end of the parking lot.

MIDTOWN: Public parking at Hemlock and Gower Street with beach access at the west end of Gower.

DOWNTOWN: Public parking between 1st and 2nd Streets and Spruce. Beach access at the west end of 2nd Street.

Haystack Rock

This monolith towers 235 feet over the beach at water's edge. Haystack is protected as a State of Oregon designated Marine Garden and is part of the Oregon Islands National Wildlife Refuge. Tide pools can be viewed at low tides and during the spring and summer, tufted puffins and other seabirds nest here. Climbing or collecting is strictly prohibited. The nearest public parking and beach access is in Midtown at Gower Street.

Ecola State Park

Perched on the edge of Tillamook Head at the north end of Cannon Beach, Ecola State park offers dramatic views, picnic areas, hiking trails and paved walkways. This is a day use park with a per vehicle fee of \$5. ADA accessible amenities in the park include parking, restrooms and picnic tables. Some trails are closed due to storm damage.



Haystack Rock

Needles

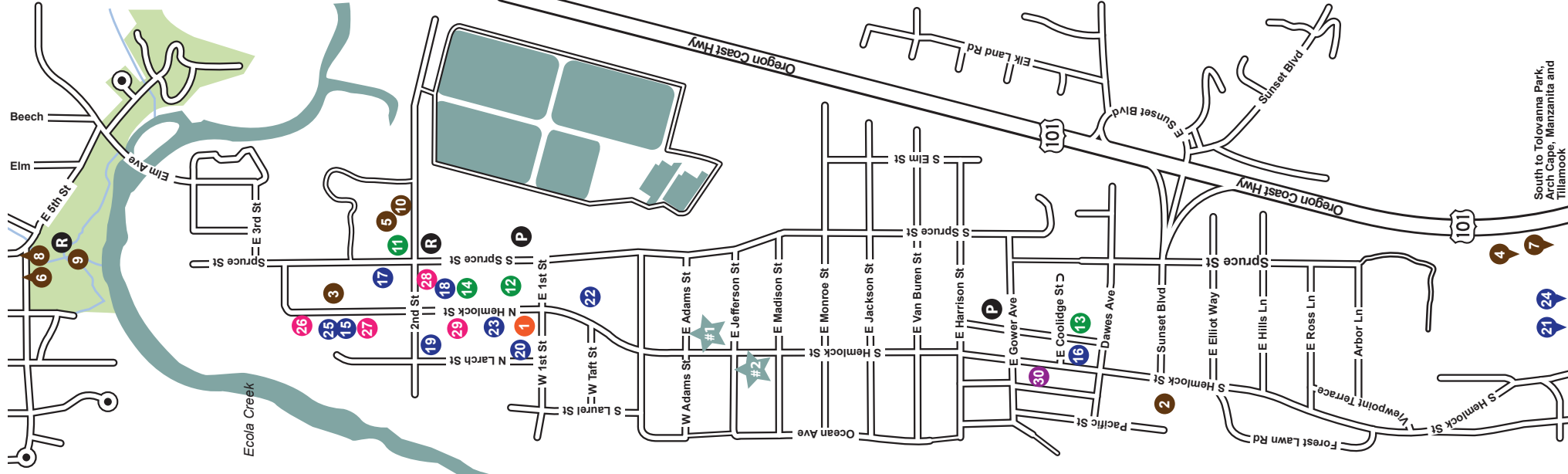

South to Tolovana Park, Arch Cape, Manzanita and Tillamook

Entertainment

1 Coaster Theatre Playhouse

Recreation

- 2 Elements by the Sea Spa
- 3 Ocean Spa
- 4 Arcadia Beach
- 5 City Park/Tennis Courts
- 6 Ecola State Park
- 7 Hug Point
- 8 Indian Beach
- 9 Les Shirley Park
- 10 Skate Park

Public Services

- 11 Chamber of Commerce
- 12 Library
- 13 Police Station
- 14 Post Office

Restaurants/Cafe

- 15 Cannon Beach Bakery
- 16 CB Hardware & Public House
- 17 Chocolate Café
- 18 Driftwood Restaurant & Lounge
- 19 Insomnia Coffee Co.
- 20 Lazy Susan Café
- 21 Mo's at Tolovana
- 22 Pig N' Pancake
- 23 Schwietert's Cones & Candy
- 24 Sea Level Bakery & Coffee
- 25 Tom's Fish & Chips

Shopping/Retail

- 26 Bruce's Candy Kitchen
- 27 The Landing
- 28 Cannon Beach Mall
- 29 Sandpiper Square
- 30 Cannon Beach Family Market

R Restrooms

P Parking

HR Inn at Haystack Rock Site 1

HR Inn at Haystack Rock Site 2